

Resultaten Spoorlijn Utrecht – Duitse grens, oorspronkelijke situatie (140 km/uur)

Model: Situatie 2010-2015 140_km/u zonder maatregelen - Op basis toekomstprognose 2010/15 - Railverkeerslawaaï - Besluit MER Ede-Oost
 Bijdrage van hoofdgroep op alle ontvangerpunten
 Rekenmethode Railverkeerslawaaï - RMR-2006; Periode: Alle perioden

Id	Omschrijving	Hoogte	Dag	Avond	Nacht	Lden
BP_10_A	ENKA	1.5	35.14	32.12	26.57	36.03
BP_10_B	ENKA	5.0	37.13	34.20	28.66	38.07
BP_10_C	ENKA	7.5	38.38	35.50	29.97	39.36
BP_10_D	ENKA	10.5	41.15	38.25	32.70	42.11
BP_11_A	ENKA	1.5	39.39	36.19	30.59	40.15
BP_11_B	ENKA	5.0	41.12	38.04	32.46	41.96
BP_11_C	ENKA	7.5	41.42	38.34	32.76	42.26
BP_11_D	ENKA	10.5	41.03	37.99	32.41	41.89
BP_12_A	ENKA	1.5	31.04	28.09	22.52	31.96
BP_12_B	ENKA	5.0	33.75	30.96	25.42	34.78
BP_12_C	ENKA	7.5	35.09	32.34	26.82	36.15
BP_12_D	ENKA	10.5	38.79	35.95	30.41	39.79
BP_13_A	ENKA	1.5	32.79	29.84	24.30	33.72
BP_13_B	ENKA	5.0	35.44	32.60	27.08	36.44
BP_13_C	ENKA	7.5	36.72	33.88	28.36	37.72
BP_13_D	ENKA	10.5	40.70	37.84	32.31	41.69
BP_14_A	ENKA	1.5	39.50	36.30	30.69	40.26
BP_14_B	ENKA	5.0	41.44	38.36	32.78	42.28
BP_14_C	ENKA	7.5	41.84	38.77	33.19	42.68
BP_14_D	ENKA	10.5	41.44	38.38	32.80	42.29
BP_15_A	ENKA	1.5	39.28	36.09	30.50	40.05
BP_15_B	ENKA	5.0	41.25	38.18	32.61	42.10
BP_15_C	ENKA	7.5	41.68	38.61	33.04	42.53
BP_15_D	ENKA	10.5	41.47	38.43	32.86	42.34
BP_16_A	ENKA	1.5	37.73	34.61	29.03	38.55
BP_16_B	ENKA	5.0	39.92	36.91	31.35	40.81
BP_16_C	ENKA	7.5	40.67	37.67	32.11	41.56
BP_16_D	ENKA	10.5	42.00	39.03	33.47	42.91
BP_17_A	ENKA	1.5	35.43	32.32	26.73	36.25
BP_17_B	ENKA	5.0	38.10	35.13	29.57	39.01
BP_17_C	ENKA	7.5	39.47	36.55	30.99	40.41
BP_17_D	ENKA	10.5	41.73	38.82	33.26	42.68
BP_18_A	ENKA	1.5	34.19	31.13	25.55	35.04
BP_18_B	ENKA	5.0	37.10	34.17	28.62	38.04
BP_18_C	ENKA	7.5	38.74	35.85	30.30	39.70
BP_18_D	ENKA	10.5	41.29	38.37	32.82	42.24
BP_19_A	ENKA	1.5	33.07	30.23	24.69	34.07
BP_19_B	ENKA	5.0	36.59	33.82	28.29	37.63
BP_19_C	ENKA	7.5	38.43	35.63	30.09	39.45
BP_19_D	ENKA	10.5	41.51	38.59	33.03	42.45
BP_1_A	ENKA	1.5	32.68	29.54	23.94	33.48
BP_1_B	ENKA	5.0	35.26	32.31	26.75	36.18
BP_1_C	ENKA	7.5	36.46	33.55	28.00	37.41
BP_1_D	ENKA	10.5	35.92	33.07	27.52	36.91
BP_20_A	ENKA	1.5	34.55	31.76	26.23	35.58
BP_20_B	ENKA	5.0	37.99	35.19	29.67	39.02
BP_20_C	ENKA	7.5	39.74	36.88	31.34	40.73
BP_20_D	ENKA	10.5	42.40	39.46	33.90	43.33
BP_21_A	ENKA	1.5	35.92	33.14	27.62	36.96
BP_21_B	ENKA	5.0	39.74	36.99	31.47	40.80
BP_21_C	ENKA	7.5	42.21	39.32	33.78	43.18
BP_21_D	ENKA	10.5	44.45	41.49	35.93	45.37
BP_22_A	ENKA	1.5	36.44	33.64	28.12	37.47
BP_22_B	ENKA	5.0	40.47	37.70	32.18	41.52
BP_22_C	ENKA	7.5	43.06	40.16	34.62	44.02
BP_22_D	ENKA	10.5	45.17	42.19	36.64	46.08
BP_23_A	ENKA	1.5	38.62	35.63	30.07	39.52
BP_23_B	ENKA	5.0	41.19	38.31	32.78	42.17
BP_23_C	ENKA	7.5	42.09	39.22	33.69	43.07
BP_23_D	ENKA	10.5	44.23	41.33	35.80	45.19
BP_24_A	ENKA	1.5	34.37	31.48	25.95	35.34
BP_24_B	ENKA	5.0	36.95	34.15	28.63	37.98
BP_24_C	ENKA	7.5	38.23	35.45	29.94	39.28
BP_24_D	ENKA	10.5	40.40	37.62	32.11	41.45
BP_25_A	ENKA	1.5	31.31	28.47	22.94	32.31
BP_25_B	ENKA	5.0	35.44	32.67	27.15	36.49
BP_25_C	ENKA	7.5	38.95	36.23	30.71	40.03
BP_25_D	ENKA	10.5	41.50	38.67	33.13	42.50
BP_26_A	ENKA	1.5	30.74	27.90	22.36	31.74
BP_26_B	ENKA	5.0	34.79	32.01	26.48	35.83
BP_26_C	ENKA	7.5	37.76	35.01	29.49	38.82
BP_26_D	ENKA	10.5	40.92	38.05	32.51	41.90
BP_27_A	ENKA	1.5	29.63	26.75	21.19	30.60
BP_27_B	ENKA	5.0	33.34	30.47	24.92	34.32
BP_27_C	ENKA	7.5	36.55	33.67	28.12	37.52
BP_27_D	ENKA	10.5	41.01	38.01	32.43	41.90
BP_28_A	ENKA	1.5	31.18	28.32	22.77	32.16
BP_28_B	ENKA	5.0	35.48	32.69	27.16	36.51
BP_28_C	ENKA	7.5	38.08	35.26	29.72	39.09
BP_28_D	ENKA	10.5	42.19	39.30	33.75	43.15
BP_29_A	ENKA	1.5	31.82	28.94	23.40	32.79
BP_29_B	ENKA	5.0	35.15	32.29	26.75	36.14
BP_29_C	ENKA	7.5	37.54	34.65	29.10	38.50
BP_29_D	ENKA	10.5	41.84	38.81	33.24	42.71
BP_2_A	ENKA	1.5	39.70	36.53	30.93	40.48
BP_2_B	ENKA	5.0	41.48	38.42	32.84	42.33
BP_2_C	ENKA	7.5	41.81	38.75	33.17	42.66
BP_2_D	ENKA	10.5	41.53	38.48	32.90	42.39
BP_30_A	ENKA	1.5	29.24	26.35	20.80	30.20

Alle getoonde dB-waarden zijn A-gewogen

Model: Situatie 2010-2015 140_km/u zonder maatregelen - Op basis toekomstprognose 2010/15 - Railverkeerslawaaï - Besluit MER Ede-Oost
 Bijdrage van hoofdgroep op alle ontvangerpunten
 Rekenmethode Railverkeerslawaaï - RMR-2006; Periode: Alle perioden

Id	Omschrijving	Hoogte	Dag	Avond	Nacht	Lden
BP_30_B	ENKA	5.0	32.25	29.43	23.90	33.26
BP_30_C	ENKA	7.5	35.29	32.50	26.97	36.32
BP_30_D	ENKA	10.5	38.69	35.85	30.32	39.69
BP_31_A	ENKA	1.5	33.49	30.33	24.73	34.27
BP_31_B	ENKA	5.0	35.82	32.80	27.23	36.70
BP_31_C	ENKA	7.5	36.29	33.26	27.68	37.16
BP_31_D	ENKA	10.5	21.17	18.53	13.02	22.30
BP_32_A	ENKA	1.5	36.36	33.33	27.77	37.24
BP_32_B	ENKA	5.0	39.02	36.11	30.57	39.98
BP_32_C	ENKA	7.5	40.28	37.41	31.88	41.26
BP_32_D	ENKA	10.5	42.38	39.48	33.94	43.34
BP_33_A	ENKA	1.5	29.15	26.32	20.79	30.16
BP_33_B	ENKA	5.0	33.21	30.43	24.91	34.25
BP_33_C	ENKA	7.5	35.62	32.82	27.29	36.65
BP_33_D	ENKA	10.5	39.54	36.72	31.18	40.55
BP_34_A	ENKA	1.5	32.25	29.30	23.75	33.18
BP_34_B	ENKA	5.0	34.85	31.97	26.43	35.82
BP_34_C	ENKA	7.5	36.20	33.29	27.74	37.15
BP_34_D	ENKA	10.5	39.78	36.76	31.19	40.66
BP_35_A	ENKA	1.5	32.27	29.32	23.77	33.20
BP_35_B	ENKA	5.0	34.76	31.90	26.37	35.75
BP_35_C	ENKA	7.5	36.17	33.30	27.76	37.15
BP_35_D	ENKA	10.5	39.13	36.14	30.58	40.03
BP_36_A	ENKA	1.5	29.97	26.98	21.42	30.87
BP_36_B	ENKA	5.0	32.75	29.89	24.35	33.74
BP_36_C	ENKA	7.5	34.37	31.52	25.98	35.36
BP_36_D	ENKA	10.5	37.30	34.38	28.84	38.25
BP_37_A	ENKA	1.5	31.87	29.01	23.47	32.86
BP_37_B	ENKA	5.0	36.08	33.28	27.75	37.11
BP_37_C	ENKA	7.5	38.66	35.87	30.35	39.70
BP_37_D	ENKA	10.5	41.26	38.39	32.85	42.24
BP_38_A	ENKA	1.5	31.60	28.75	23.21	32.59
BP_38_B	ENKA	5.0	35.66	32.86	27.33	36.69
BP_38_C	ENKA	7.5	38.43	35.65	30.12	39.47
BP_38_D	ENKA	10.5	40.84	37.98	32.45	41.83
BP_39_A	ENKA	1.5	31.47	28.62	23.09	32.46
BP_39_B	ENKA	5.0	35.48	32.69	27.17	36.52
BP_39_C	ENKA	7.5	37.97	35.18	29.66	39.01
BP_39_D	ENKA	10.5	40.85	38.02	32.49	41.86
BP_3_A	ENKA	1.5	34.92	31.87	26.30	35.78
BP_3_B	ENKA	5.0	36.94	33.99	28.44	37.87
BP_3_C	ENKA	7.5	38.10	35.23	29.69	39.08
BP_3_D	ENKA	10.5	40.27	37.41	31.87	41.26
BP_40_A	ENKA	1.5	31.62	28.78	23.24	32.62
BP_40_B	ENKA	5.0	35.64	32.86	27.34	36.68
BP_40_C	ENKA	7.5	38.19	35.43	29.90	39.24
BP_40_D	ENKA	10.5	40.83	38.00	32.47	41.84
BP_41_A	ENKA	1.5	31.66	28.82	23.29	32.66
BP_41_B	ENKA	5.0	35.30	32.52	27.00	36.34
BP_41_C	ENKA	7.5	38.30	35.56	30.04	39.37
BP_41_D	ENKA	10.5	41.00	38.18	32.64	42.01
BP_42_A	ENKA	1.5	31.00	28.13	22.58	31.98
BP_42_B	ENKA	5.0	35.19	32.42	26.90	36.24
BP_42_C	ENKA	7.5	37.30	34.52	28.99	38.34
BP_42_D	ENKA	10.5	40.58	37.71	32.16	41.56
BP_43_A	ENKA	1.5	31.24	28.37	22.83	32.22
BP_43_B	ENKA	5.0	35.43	32.65	27.12	36.47
BP_43_C	ENKA	7.5	37.89	35.10	29.57	38.92
BP_43_D	ENKA	10.5	40.82	37.90	32.35	41.77
BP_4_A	ENKA	1.5	34.91	31.88	26.32	35.79
BP_4_B	ENKA	5.0	36.93	34.01	28.47	37.88
BP_4_C	ENKA	7.5	37.88	34.98	29.45	38.84
BP_4_D	ENKA	10.5	39.74	36.83	31.29	40.70
BP_51_A	ENKA overig	1.5	44.66	41.27	35.63	45.30
BP_51_B	ENKA overig	5.0	47.12	43.97	38.38	47.91
BP_51_C	ENKA overig	7.5	47.34	44.21	38.62	48.15
BP_51_D	ENKA overig	10.5	47.20	44.07	38.49	48.01
BP_52_A	ENKA overig	1.5	45.63	42.18	36.53	46.23
BP_52_B	ENKA overig	5.0	47.97	44.78	39.17	48.73
BP_52_C	ENKA overig	7.5	48.18	45.01	39.41	48.96
BP_52_D	ENKA overig	10.5	47.98	44.81	39.22	48.76
BP_53_A	ENKA overig	1.5	46.99	43.53	37.87	47.58
BP_53_B	ENKA overig	5.0	49.31	46.11	40.50	50.07
BP_53_C	ENKA overig	7.5	49.55	46.36	40.76	50.32
BP_53_D	ENKA overig	10.5	49.51	46.32	40.71	50.27
BP_54_A	ENKA overig	1.5	49.26	45.74	40.08	49.82
BP_54_B	ENKA overig	5.0	51.42	48.15	42.54	52.14
BP_54_C	ENKA overig	7.5	51.76	48.49	42.88	52.48
BP_54_D	ENKA overig	10.5	52.03	48.77	43.16	52.75
BP_55_A	ENKA overig	1.5	50.13	46.57	40.91	50.67
BP_55_B	ENKA overig	5.0	52.39	49.09	43.47	53.09
BP_55_C	ENKA overig	7.5	52.82	49.52	43.91	53.52
BP_55_D	ENKA overig	10.5	53.26	49.96	44.35	53.96
BP_56_A	ENKA overig	1.5	48.94	45.35	39.68	49.45
BP_56_B	ENKA overig	5.0	51.19	47.86	42.23	51.87
BP_56_C	ENKA overig	7.5	51.66	48.33	42.71	52.34
BP_56_D	ENKA overig	10.5	52.15	48.82	43.20	52.83
BP_57_A	ENKA overig	1.5	46.43	42.81	37.13	46.92
BP_57_B	ENKA overig	5.0	48.87	45.53	39.90	49.54

Alle getoonde dB-waarden zijn A-gewogen

Model: Situatie 2010-2015 140_km/u zonder maatregelen - Op basis toekomstprognose 2010/15 - Railverkeerslawaaï - Besluit MER Ede-Oost
 Bijdrage van hoofdgroep op alle ontvangerpunten
 Rekenmethode Railverkeerslawaaï - RMR-2006; Periode: Alle perioden

Id	Omschrijving	Hoogte	Dag	Avond	Nacht	Lden
BP_57_C	ENKA overig	10.0	50.07	46.72	41.10	50.74
BP_57_D	ENKA overig	15.0	50.93	47.55	41.93	51.58
BP_57_E	ENKA overig	20.0	51.20	47.81	42.19	51.85
BP_58_A	ENKA overig	1.5	56.00	52.36	46.68	56.48
BP_58_B	ENKA overig	5.0	59.27	55.88	50.25	59.91
BP_58_C	ENKA overig	10.0	59.85	56.45	50.82	60.49
BP_58_D	ENKA overig	15.0	59.96	56.53	50.90	60.58
BP_58_E	ENKA overig	20.0	59.93	56.51	50.88	60.55
BP_59_A	ENKA overig	1.5	62.53	59.00	53.34	63.08
BP_59_B	ENKA overig	5.0	65.49	62.20	56.59	66.20
BP_59_C	ENKA overig	10.0	65.76	62.45	56.84	66.45
BP_59_D	ENKA overig	15.0	65.71	62.41	56.79	66.41
BP_59_E	ENKA overig	20.0	65.64	62.34	56.72	66.34
BP_5_A	ENKA	1.5	39.78	36.62	31.03	40.57
BP_5_B	ENKA	5.0	41.34	38.27	32.69	42.18
BP_5_C	ENKA	7.5	41.68	38.62	33.04	42.53
BP_5_D	ENKA	10.0	41.54	38.50	32.92	42.40
BP_60_A	ENKA overig	1.5	62.71	59.25	53.61	63.31
BP_60_B	ENKA overig	5.0	65.71	62.46	56.86	66.44
BP_60_C	ENKA overig	10.0	65.84	62.59	56.99	66.57
BP_60_D	ENKA overig	15.0	65.73	62.49	56.89	66.47
BP_60_E	ENKA overig	20.0	65.57	62.33	56.73	66.31
BP_61_A	ENKA overig	1.5	62.72	59.39	53.77	63.40
BP_61_B	ENKA overig	5.0	65.74	62.58	57.00	66.53
BP_61_C	ENKA overig	10.0	65.85	62.70	57.12	66.65
BP_61_D	ENKA overig	15.0	65.74	62.59	57.00	66.53
BP_61_E	ENKA overig	20.0	65.57	62.42	56.83	66.36
BP_62_A	ENKA overig	1.5	62.56	59.27	53.67	63.27
BP_62_B	ENKA overig	5.0	65.59	62.47	56.89	66.41
BP_62_C	ENKA overig	7.5	65.74	62.62	57.05	66.56
BP_62_D	ENKA overig	10.5	65.73	62.61	57.03	66.55
BP_62_E	ENKA overig	13.5	65.67	62.55	56.98	66.49
BP_63_A	ENKA overig	1.5	62.55	59.34	53.75	63.31
BP_63_B	ENKA overig	5.0	65.57	62.51	56.94	66.42
BP_63_C	ENKA overig	7.5	65.74	62.68	57.11	66.59
BP_63_D	ENKA overig	10.5	65.74	62.68	57.11	66.59
BP_63_E	ENKA overig	13.5	65.68	62.63	57.06	66.54
BP_64_A	ENKA overig	1.5	62.49	59.33	53.75	63.28
BP_64_B	ENKA overig	5.0	65.50	62.47	56.91	66.38
BP_64_C	ENKA overig	7.5	65.69	62.67	57.11	66.57
BP_64_D	ENKA overig	10.5	65.70	62.67	57.11	66.58
BP_64_E	ENKA overig	13.5	65.65	62.63	57.07	66.53
BP_65_A	ENKA overig	1.5	56.17	53.05	47.48	56.99
BP_65_B	ENKA overig	5.0	58.23	55.19	49.64	59.10
BP_65_C	ENKA overig	7.5	58.90	55.87	50.31	59.78
BP_65_D	ENKA overig	10.5	59.67	56.64	51.09	60.55
BP_66_A	ENKA overig	1.5	58.58	55.48	49.92	59.41
BP_66_B	ENKA overig	5.0	60.76	57.74	52.19	61.65
BP_66_C	ENKA overig	7.5	61.55	58.54	52.99	62.44
BP_66_D	ENKA overig	10.5	62.19	59.19	53.64	63.09
BP_67_A	ENKA overig	1.5	59.30	56.28	50.73	60.19
BP_67_B	ENKA overig	5.0	61.38	58.43	52.89	62.31
BP_67_C	ENKA overig	7.5	62.16	59.22	53.68	63.10
BP_67_D	ENKA overig	10.5	62.84	59.91	54.37	63.78
BP_68_A	ENKA overig	1.5	59.68	56.72	51.18	60.61
BP_68_B	ENKA overig	5.0	61.44	58.53	53.00	62.40
BP_68_C	ENKA overig	7.5	62.20	59.29	53.76	63.16
BP_68_D	ENKA overig	10.5	62.89	59.99	54.46	63.85
BP_69_A	ENKA overig	1.5	59.56	56.63	51.09	60.50
BP_69_B	ENKA overig	5.0	61.25	58.35	52.82	62.21
BP_69_C	ENKA overig	7.5	62.00	59.11	53.58	62.97
BP_69_D	ENKA overig	10.5	62.70	59.81	54.28	63.67
BP_6_A	ENKA	1.5	33.98	30.92	25.34	34.83
BP_6_B	ENKA	5.0	35.47	32.50	26.95	36.39
BP_6_C	ENKA	7.5	36.77	33.89	28.35	37.74
BP_6_D	ENKA	10.5	39.40	36.54	31.00	40.39
BP_70_A	ENKA overig	1.5	58.95	56.02	50.49	59.90
BP_70_B	ENKA overig	5.0	60.53	57.64	52.11	61.50
BP_70_C	ENKA overig	7.5	61.30	58.41	52.88	62.27
BP_70_D	ENKA overig	10.5	61.91	59.03	53.50	62.89
BP_71_A	ENKA overig	1.5	57.13	54.20	48.67	58.08
BP_71_B	ENKA overig	5.0	58.84	55.95	50.42	59.81
BP_71_C	ENKA overig	7.5	59.58	56.69	51.16	60.55
BP_71_D	ENKA overig	10.5	60.32	57.44	51.91	61.30
BP_72_A	ENKA overig	1.5	56.59	53.70	48.17	57.56
BP_72_B	ENKA overig	5.0	58.27	55.40	49.88	59.26
BP_72_C	ENKA overig	7.5	59.03	56.16	50.64	60.02
BP_72_D	ENKA overig	10.5	59.65	56.79	51.26	60.64
BP_73_A	ENKA overig	1.5	50.72	47.84	42.31	51.70
BP_73_B	ENKA overig	5.0	52.80	49.95	44.43	53.80
BP_73_C	ENKA overig	7.5	53.42	50.58	45.06	54.42
BP_73_D	ENKA overig	10.5	54.09	51.25	45.73	55.09
BP_74_A	ENKA overig	1.5	48.94	46.07	40.54	49.92
BP_74_B	ENKA overig	5.0	50.43	47.59	42.07	51.43
BP_74_C	ENKA overig	7.5	50.93	48.09	42.57	51.93
BP_74_D	ENKA overig	10.5	51.44	48.60	43.08	52.44
BP_75_A	ENKA overig	1.5	47.45	44.60	39.08	48.45
BP_75_B	ENKA overig	5.0	48.50	45.68	40.16	49.52
BP_75_C	ENKA overig	7.5	48.91	46.08	40.57	49.92

Alle getoonde dB-waarden zijn A-gewogen

Model: Situatie 2010-2015 140_km/u zonder maatregelen - Op basis toekomstprognose 2010/15 - Railverkeerslawaaï - Besluit MER Ede-Oost
Bijdrage van hoofdgroep op alle ontvangerpunten
Rekenmethode Railverkeerslawaaï - RMR-2006; Periode: Alle perioden

Id	Omschrijving	Hoogte	Dag	Avond	Nacht	Lden
BP_75_D	ENKA overig	10.5	49.35	46.53	41.01	50.37
BP_7_A	ENKA	1.5	35.36	32.32	26.76	36.23
BP_7_B	ENKA	5.0	37.31	34.38	28.83	38.25
BP_7_C	ENKA	7.5	38.30	35.40	29.87	39.26
BP_7_D	ENKA	10.5	40.56	37.65	32.11	41.52
BP_8_A	ENKA	1.5	39.87	36.69	31.09	40.64
BP_8_B	ENKA	5.0	41.45	38.37	32.79	42.29
BP_8_C	ENKA	7.5	41.78	38.71	33.13	42.62
BP_8_D	ENKA	10.5	41.60	38.53	32.95	42.44
BP_9_A	ENKA	1.5	35.64	32.55	26.97	36.47
BP_9_B	ENKA	5.0	37.51	34.53	28.97	38.42
BP_9_C	ENKA	7.5	38.52	35.61	30.07	39.48
BP_9_D	ENKA	10.5	40.28	37.42	31.88	41.27

Alle getoonde dB-waarden zijn A-gewogen

Resultaten Spoorlijn Utrecht – Duitse grens, situatie 160 km/uur

Model: Situatie 2010-2015 160_km/u zonder maatregelen - Op basis toekomstprognose 2010/15 - Railverkeerslawaaï - Besluit MER Ede-Oost
 Bijdrage van hoofdgroep op alle ontvangerpunten
 Rekenmethode Railverkeerslawaaï - RMR-2006; Periode: Alle perioden

Id	Omschrijving	Hoogte	Dag	Avond	Nacht	Lden
BP_10_A	ENKA	1.5	35.24	32.32	26.74	36.17
BP_10_B	ENKA	5.0	37.21	34.37	28.81	38.20
BP_10_C	ENKA	7.5	38.44	35.61	30.07	39.44
BP_10_D	ENKA	10.5	41.37	38.50	32.97	42.35
BP_11_A	ENKA	1.5	38.56	35.62	30.00	39.47
BP_11_B	ENKA	5.0	40.30	37.44	31.84	41.26
BP_11_C	ENKA	7.5	40.59	37.72	32.12	41.55
BP_11_D	ENKA	10.5	40.76	37.87	32.27	41.70
BP_12_A	ENKA	1.5	30.53	27.70	22.13	31.52
BP_12_B	ENKA	5.0	33.36	30.61	25.08	34.42
BP_12_C	ENKA	7.5	34.94	32.20	26.69	36.01
BP_12_D	ENKA	10.5	38.69	35.89	30.35	39.71
BP_13_A	ENKA	1.5	32.90	30.06	24.50	33.89
BP_13_B	ENKA	5.0	35.51	32.74	27.20	36.55
BP_13_C	ENKA	7.5	36.79	34.01	28.48	37.83
BP_13_D	ENKA	10.5	40.86	38.02	32.48	41.86
BP_14_A	ENKA	1.5	38.68	35.71	30.09	39.57
BP_14_B	ENKA	5.0	40.86	37.69	32.08	41.51
BP_14_C	ENKA	7.5	41.02	38.15	32.55	41.98
BP_14_D	ENKA	10.5	41.19	38.30	32.69	42.13
BP_15_A	ENKA	1.5	38.51	35.55	29.93	39.40
BP_15_B	ENKA	5.0	40.44	37.58	31.99	41.41
BP_15_C	ENKA	7.5	40.85	37.98	32.39	41.81
BP_15_D	ENKA	10.5	41.14	38.24	32.65	42.08
BP_16_A	ENKA	1.5	36.95	34.06	28.48	37.90
BP_16_B	ENKA	5.0	39.18	36.37	30.80	40.18
BP_16_C	ENKA	7.5	40.04	37.20	31.63	41.03
BP_16_D	ENKA	10.5	41.82	38.93	33.36	42.78
BP_17_A	ENKA	1.5	34.02	31.24	25.65	35.03
BP_17_B	ENKA	5.0	36.97	34.23	28.66	38.02
BP_17_C	ENKA	7.5	38.69	35.91	30.35	39.72
BP_17_D	ENKA	10.5	41.52	38.66	33.11	42.50
BP_18_A	ENKA	1.5	33.20	30.39	24.81	34.20
BP_18_B	ENKA	5.0	36.31	33.54	27.98	37.34
BP_18_C	ENKA	7.5	38.25	35.45	29.90	39.27
BP_18_D	ENKA	10.5	41.21	38.35	32.80	42.19
BP_19_A	ENKA	1.5	33.05	30.24	24.69	34.06
BP_19_B	ENKA	5.0	36.55	33.79	28.26	37.60
BP_19_C	ENKA	7.5	38.50	35.71	30.18	39.53
BP_19_D	ENKA	10.5	41.43	38.59	33.03	42.42
BP_1_A	ENKA	1.5	32.01	29.04	23.43	32.90
BP_1_B	ENKA	5.0	34.59	31.73	26.17	35.57
BP_1_C	ENKA	7.5	35.91	33.05	27.51	36.90
BP_1_D	ENKA	10.5	35.66	32.83	27.29	36.66
BP_20_A	ENKA	1.5	34.51	31.75	26.22	35.56
BP_20_B	ENKA	5.0	37.74	35.03	29.51	38.82
BP_20_C	ENKA	7.5	39.10	36.36	30.83	40.16
BP_20_D	ENKA	10.5	41.92	39.10	33.54	42.92
BP_21_A	ENKA	1.5	35.93	33.17	27.64	36.98
BP_21_B	ENKA	5.0	39.83	37.11	31.59	40.91
BP_21_C	ENKA	7.5	41.26	38.55	33.02	42.34
BP_21_D	ENKA	10.5	43.10	40.38	34.81	44.16
BP_22_A	ENKA	1.5	36.44	33.68	28.14	37.49
BP_22_B	ENKA	5.0	40.53	37.80	32.28	41.60
BP_22_C	ENKA	7.5	41.85	39.16	33.62	42.94
BP_22_D	ENKA	10.5	43.32	40.63	35.06	44.40
BP_23_A	ENKA	1.5	35.02	32.36	26.80	36.12
BP_23_B	ENKA	5.0	38.66	36.00	30.46	39.77
BP_23_C	ENKA	7.5	40.06	37.38	31.85	41.16
BP_23_D	ENKA	10.5	42.82	40.10	34.55	43.89
BP_24_A	ENKA	1.5	32.35	29.65	24.12	33.44
BP_24_B	ENKA	5.0	35.50	32.84	27.31	36.61
BP_24_C	ENKA	7.5	37.15	34.49	28.97	38.26
BP_24_D	ENKA	10.5	39.67	36.99	31.48	40.78
BP_25_A	ENKA	1.5	31.39	28.63	23.08	32.43
BP_25_B	ENKA	5.0	35.47	32.73	27.21	36.54
BP_25_C	ENKA	7.5	38.94	36.20	30.69	40.01
BP_25_D	ENKA	10.5	41.55	38.76	33.22	42.58
BP_26_A	ENKA	1.5	30.80	28.02	22.47	31.83
BP_26_B	ENKA	5.0	34.83	32.07	26.54	35.88
BP_26_C	ENKA	7.5	37.78	35.03	29.51	38.84
BP_26_D	ENKA	10.5	41.01	38.19	32.65	42.02
BP_27_A	ENKA	1.5	29.70	26.88	21.31	30.70
BP_27_B	ENKA	5.0	33.40	30.58	25.02	34.40
BP_27_C	ENKA	7.5	36.83	33.99	28.44	37.82
BP_27_D	ENKA	10.5	41.03	38.17	32.58	42.00
BP_28_A	ENKA	1.5	31.24	28.42	22.87	32.25
BP_28_B	ENKA	5.0	35.48	32.69	27.17	36.52
BP_28_C	ENKA	7.5	38.13	35.32	29.79	39.15
BP_28_D	ENKA	10.5	42.17	39.35	33.80	43.18
BP_29_A	ENKA	1.5	31.92	29.13	23.56	32.94
BP_29_B	ENKA	5.0	35.32	32.53	26.98	36.34
BP_29_C	ENKA	7.5	37.64	34.83	29.27	38.65
BP_29_D	ENKA	10.5	41.59	38.72	33.13	42.55
BP_2_A	ENKA	1.5	38.90	35.95	30.33	39.80
BP_2_B	ENKA	5.0	40.70	37.83	32.23	41.66
BP_2_C	ENKA	7.5	41.02	38.14	32.55	41.97
BP_2_D	ENKA	10.5	40.84	37.97	32.36	41.79
BP_30_A	ENKA	1.5	29.35	26.56	21.00	30.37

Alle getoonde dB-waarden zijn A-gewogen

Model: Situatie 2010-2015 160_km/u zonder maatregelen - Op basis toekomstprognose 2010/15 - Railverkeerslawaaï - Besluit MER Ede-Oost
 Bijdrage van hoofdgroep op alle ontvangerpunten
 Rekenmethode Railverkeerslawaaï - RMR-2006; Periode: Alle perioden

Id	Omschrijving	Hoogte	Dag	Avond	Nacht	Lden
BP_30_B	ENKA	5.0	32.36	29.63	24.08	33.42
BP_30_C	ENKA	7.5	35.11	32.38	26.85	36.18
BP_30_D	ENKA	10.5	38.71	35.92	30.38	39.74
BP_31_A	ENKA	1.5	32.59	29.62	24.01	33.48
BP_31_B	ENKA	5.0	34.97	32.11	26.53	35.94
BP_31_C	ENKA	7.5	35.19	32.27	26.70	36.13
BP_31_D	ENKA	10.5	21.01	18.50	12.96	22.21
BP_32_A	ENKA	1.5	35.71	32.90	27.32	36.71
BP_32_B	ENKA	5.0	38.38	35.62	30.07	39.42
BP_32_C	ENKA	7.5	39.80	37.04	31.50	40.85
BP_32_D	ENKA	10.5	42.25	39.43	33.88	43.26
BP_33_A	ENKA	1.5	29.16	26.38	20.84	30.19
BP_33_B	ENKA	5.0	33.19	30.41	24.89	34.23
BP_33_C	ENKA	7.5	35.62	32.83	27.31	36.66
BP_33_D	ENKA	10.5	39.50	36.73	31.19	40.54
BP_34_A	ENKA	1.5	32.28	29.39	23.82	33.24
BP_34_B	ENKA	5.0	34.86	32.03	26.47	35.86
BP_34_C	ENKA	7.5	36.27	33.40	27.85	37.25
BP_34_D	ENKA	10.5	39.32	36.44	30.86	40.28
BP_35_A	ENKA	1.5	32.32	29.42	23.86	33.27
BP_35_B	ENKA	5.0	34.80	31.97	26.43	35.80
BP_35_C	ENKA	7.5	36.20	33.36	27.82	37.20
BP_35_D	ENKA	10.5	38.98	36.10	30.54	39.95
BP_36_A	ENKA	1.5	30.05	27.14	21.56	30.99
BP_36_B	ENKA	5.0	32.80	29.99	24.44	33.81
BP_36_C	ENKA	7.5	34.33	31.54	25.99	35.35
BP_36_D	ENKA	10.5	37.46	34.66	29.11	38.48
BP_37_A	ENKA	1.5	31.89	29.06	23.52	32.89
BP_37_B	ENKA	5.0	36.08	33.26	27.74	37.10
BP_37_C	ENKA	7.5	38.65	35.84	30.32	39.67
BP_37_D	ENKA	10.5	41.10	38.33	32.77	42.13
BP_38_A	ENKA	1.5	31.62	28.79	23.25	32.62
BP_38_B	ENKA	5.0	35.65	32.84	27.31	36.67
BP_38_C	ENKA	7.5	38.41	35.61	30.09	39.44
BP_38_D	ENKA	10.5	40.71	37.95	32.41	41.76
BP_39_A	ENKA	1.5	31.49	28.66	23.12	32.49
BP_39_B	ENKA	5.0	35.47	32.66	27.14	36.49
BP_39_C	ENKA	7.5	38.08	35.28	29.76	39.11
BP_39_D	ENKA	10.5	40.72	37.95	32.42	41.76
BP_3_A	ENKA	1.5	34.12	31.34	25.76	35.14
BP_3_B	ENKA	5.0	36.18	33.46	27.89	37.24
BP_3_C	ENKA	7.5	37.52	34.78	29.24	38.58
BP_3_D	ENKA	10.5	40.24	37.45	31.91	41.27
BP_40_A	ENKA	1.5	31.64	28.81	23.27	32.64
BP_40_B	ENKA	5.0	35.62	32.82	27.30	36.65
BP_40_C	ENKA	7.5	38.13	35.35	29.83	39.17
BP_40_D	ENKA	10.5	40.64	37.86	32.33	41.68
BP_41_A	ENKA	1.5	31.68	28.87	23.33	32.70
BP_41_B	ENKA	5.0	35.30	32.52	27.00	36.34
BP_41_C	ENKA	7.5	38.29	35.54	30.03	39.35
BP_41_D	ENKA	10.5	40.90	38.10	32.56	41.92
BP_42_A	ENKA	1.5	31.05	28.23	22.67	32.05
BP_42_B	ENKA	5.0	35.17	32.40	26.87	36.21
BP_42_C	ENKA	7.5	37.29	34.53	29.00	38.34
BP_42_D	ENKA	10.5	40.42	37.64	32.09	41.45
BP_43_A	ENKA	1.5	31.30	28.48	22.93	32.31
BP_43_B	ENKA	5.0	35.54	32.76	27.23	36.58
BP_43_C	ENKA	7.5	37.92	35.16	29.63	38.97
BP_43_D	ENKA	10.5	40.52	37.70	32.14	41.52
BP_4_A	ENKA	1.5	35.00	32.07	26.50	35.93
BP_4_B	ENKA	5.0	37.01	34.16	28.60	37.99
BP_4_C	ENKA	7.5	37.94	35.10	29.55	38.93
BP_4_D	ENKA	10.5	39.96	37.09	31.55	40.94
BP_51_A	ENKA overig	1.5	41.53	38.63	32.97	42.45
BP_51_B	ENKA overig	5.0	44.06	41.26	35.63	45.05
BP_51_C	ENKA overig	7.5	44.44	41.63	35.99	45.42
BP_51_D	ENKA overig	10.5	44.50	41.67	36.03	45.46
BP_52_A	ENKA overig	1.5	42.04	39.21	33.52	42.99
BP_52_B	ENKA overig	5.0	44.55	41.79	36.14	45.55
BP_52_C	ENKA overig	7.5	44.92	42.14	36.49	45.91
BP_52_D	ENKA overig	10.5	44.99	42.19	36.53	45.97
BP_53_A	ENKA overig	1.5	43.09	40.28	34.58	44.04
BP_53_B	ENKA overig	5.0	45.65	42.90	37.24	46.66
BP_53_C	ENKA overig	7.5	46.09	43.33	37.66	47.09
BP_53_D	ENKA overig	10.5	46.48	43.70	38.03	47.46
BP_54_A	ENKA overig	1.5	44.46	41.76	36.04	45.47
BP_54_B	ENKA overig	5.0	47.05	44.37	38.68	48.09
BP_54_C	ENKA overig	7.5	47.73	45.03	39.34	48.75
BP_54_D	ENKA overig	10.5	48.43	45.71	40.03	49.45
BP_55_A	ENKA overig	1.5	44.61	42.02	36.28	45.68
BP_55_B	ENKA overig	5.0	47.41	44.81	39.11	48.49
BP_55_C	ENKA overig	7.5	48.29	45.67	39.97	49.36
BP_55_D	ENKA overig	10.5	49.12	46.48	40.78	50.18
BP_56_A	ENKA overig	1.5	43.71	41.10	35.35	44.77
BP_56_B	ENKA overig	5.0	46.66	44.04	38.34	47.73
BP_56_C	ENKA overig	7.5	47.61	44.97	39.26	48.66
BP_56_D	ENKA overig	10.5	48.41	45.76	40.06	49.46
BP_57_A	ENKA overig	1.5	41.89	39.17	33.41	42.88
BP_57_B	ENKA overig	5.0	45.47	42.74	37.04	46.47

Alle getoonde dB-waarden zijn A-gewogen

Model: Situatie 2010-2015 160_km/u zonder maatregelen - Op basis toekomstprognose 2010/15 - Railverkeerslawaaï - Besluit MER Ede-Oost
 Bijdrage van hoofdgroep op alle ontvangerpunten
 Rekenmethode Railverkeerslawaaï - RMR-2006; Periode: Alle perioden

Id	Omschrijving	Hoogte	Dag	Avond	Nacht	Lden
BP_57_C	ENKA overig	10.0	47.15	44.41	38.72	48.15
BP_57_D	ENKA overig	15.0	48.14	45.35	39.65	49.11
BP_57_E	ENKA overig	20.0	48.77	45.91	40.21	49.69
BP_58_A	ENKA overig	1.5	48.87	46.70	40.91	50.18
BP_58_B	ENKA overig	5.0	53.83	51.37	45.63	54.98
BP_58_C	ENKA overig	10.0	56.14	53.52	47.79	57.20
BP_58_D	ENKA overig	15.0	57.39	54.62	48.89	58.36
BP_58_E	ENKA overig	20.0	58.30	55.35	49.62	59.16
BP_59_A	ENKA overig	1.5	54.24	52.16	46.39	55.62
BP_59_B	ENKA overig	5.0	60.34	57.79	52.09	61.45
BP_59_C	ENKA overig	10.0	62.99	60.23	54.52	63.97
BP_59_D	ENKA overig	15.0	64.57	61.57	55.87	65.41
BP_59_E	ENKA overig	20.0	65.49	62.31	56.66	66.24
BP_5_A	ENKA	1.5	39.00	36.07	30.46	39.92
BP_5_B	ENKA	5.0	40.57	37.71	32.11	41.53
BP_5_C	ENKA	7.5	40.91	38.05	32.45	41.87
BP_5_D	ENKA	10.5	40.91	38.04	32.44	41.87
BP_60_A	ENKA overig	1.5	53.97	51.91	46.14	55.36
BP_60_B	ENKA overig	5.0	59.76	57.25	51.54	60.89
BP_60_C	ENKA overig	10.0	62.96	60.13	54.44	63.91
BP_60_D	ENKA overig	15.0	64.33	61.37	55.68	65.20
BP_60_E	ENKA overig	20.0	65.23	62.10	56.45	66.01
BP_61_A	ENKA overig	1.5	53.72	51.67	45.92	55.12
BP_61_B	ENKA overig	5.0	59.29	56.85	51.17	60.48
BP_61_C	ENKA overig	10.0	62.55	59.79	54.13	63.55
BP_61_D	ENKA overig	15.0	64.17	61.26	55.61	65.08
BP_61_E	ENKA overig	20.0	64.94	61.93	56.29	65.80
BP_62_A	ENKA overig	1.5	53.49	51.46	45.71	54.91
BP_62_B	ENKA overig	5.0	58.73	56.33	50.66	59.95
BP_62_C	ENKA overig	7.5	60.67	58.06	52.41	61.76
BP_62_D	ENKA overig	10.5	62.32	59.59	53.94	63.34
BP_62_E	ENKA overig	13.5	63.38	60.56	54.92	64.35
BP_63_A	ENKA overig	1.5	53.31	51.29	45.55	54.74
BP_63_B	ENKA overig	5.0	58.28	55.93	50.27	59.53
BP_63_C	ENKA overig	7.5	60.08	57.58	51.92	61.24
BP_63_D	ENKA overig	10.5	61.80	59.15	53.50	62.87
BP_63_E	ENKA overig	13.5	63.10	60.33	54.70	64.10
BP_64_A	ENKA overig	1.5	53.17	51.15	45.42	54.60
BP_64_B	ENKA overig	5.0	58.01	55.68	50.02	59.27
BP_64_C	ENKA overig	7.5	59.78	57.32	51.66	60.96
BP_64_D	ENKA overig	10.5	61.45	58.83	53.20	62.55
BP_64_E	ENKA overig	13.5	62.75	60.04	54.40	63.79
BP_65_A	ENKA overig	1.5	47.15	45.05	39.34	48.54
BP_65_B	ENKA overig	5.0	50.65	48.44	42.78	51.99
BP_65_C	ENKA overig	7.5	51.75	49.51	43.85	53.07
BP_65_D	ENKA overig	10.5	53.08	50.75	45.10	54.35
BP_66_A	ENKA overig	1.5	49.57	47.45	41.75	50.95
BP_66_B	ENKA overig	5.0	53.24	51.02	45.36	54.57
BP_66_C	ENKA overig	7.5	54.53	52.24	46.59	55.82
BP_66_D	ENKA overig	10.5	56.12	53.72	48.07	57.34
BP_67_A	ENKA overig	1.5	50.32	48.13	42.46	51.67
BP_67_B	ENKA overig	5.0	53.86	51.56	45.94	55.16
BP_67_C	ENKA overig	7.5	55.13	52.79	47.17	56.40
BP_67_D	ENKA overig	10.5	56.73	54.29	48.67	57.94
BP_68_A	ENKA overig	1.5	51.02	48.77	43.13	52.34
BP_68_B	ENKA overig	5.0	54.05	51.73	46.11	55.34
BP_68_C	ENKA overig	7.5	55.29	52.93	47.32	56.55
BP_68_D	ENKA overig	10.5	56.96	54.50	48.89	58.16
BP_69_A	ENKA overig	1.5	50.88	48.66	43.01	52.22
BP_69_B	ENKA overig	5.0	53.81	51.51	45.89	55.11
BP_69_C	ENKA overig	7.5	55.05	52.71	47.10	56.33
BP_69_D	ENKA overig	10.5	56.72	54.29	48.67	57.94
BP_6_A	ENKA	1.5	33.02	30.24	24.65	34.03
BP_6_B	ENKA	5.0	34.58	31.86	26.28	35.63
BP_6_C	ENKA	7.5	36.14	33.41	27.86	37.20
BP_6_D	ENKA	10.5	39.49	36.70	31.16	40.52
BP_70_A	ENKA overig	1.5	50.43	48.31	42.64	51.82
BP_70_B	ENKA overig	5.0	53.22	51.05	45.40	54.59
BP_70_C	ENKA overig	7.5	54.56	52.32	46.68	55.89
BP_70_D	ENKA overig	10.5	56.19	53.83	48.20	57.45
BP_71_A	ENKA overig	1.5	48.49	46.66	40.93	50.04
BP_71_B	ENKA overig	5.0	51.71	49.78	44.08	53.21
BP_71_C	ENKA overig	7.5	53.08	51.07	45.38	54.53
BP_71_D	ENKA overig	10.5	54.87	52.69	47.01	56.22
BP_72_A	ENKA overig	1.5	47.98	46.27	40.52	49.60
BP_72_B	ENKA overig	5.0	51.06	49.24	43.52	52.63
BP_72_C	ENKA overig	7.5	52.47	50.55	44.84	53.97
BP_72_D	ENKA overig	10.5	54.24	52.14	46.45	55.64
BP_73_A	ENKA overig	1.5	42.44	40.69	34.95	44.04
BP_73_B	ENKA overig	5.0	45.67	43.85	38.14	47.24
BP_73_C	ENKA overig	7.5	46.65	44.81	39.09	48.20
BP_73_D	ENKA overig	10.5	47.83	45.92	40.22	49.35
BP_74_A	ENKA overig	1.5	41.22	39.38	33.66	42.77
BP_74_B	ENKA overig	5.0	43.86	41.96	36.26	45.38
BP_74_C	ENKA overig	7.5	44.59	42.67	36.98	46.10
BP_74_D	ENKA overig	10.5	45.37	43.42	37.73	46.86
BP_75_A	ENKA overig	1.5	40.21	38.35	32.65	41.76
BP_75_B	ENKA overig	5.0	42.31	40.39	34.71	43.83
BP_75_C	ENKA overig	7.5	42.91	40.98	35.29	44.42

Alle getoonde dB-waarden zijn A-gewogen

Model: Situatie 2010-2015 160_km/u zonder maatregelen - Op basis toekomstprognose 2010/15 - Railverkeerslawaaï - Besluit MER Ede-Oost
Bijdrage van hoofdgroep op alle ontvangerpunten
Rekenmethode Railverkeerslawaaï - RMR-2006; Periode: Alle perioden

Id	Omschrijving	Hoogte	Dag	Avond	Nacht	Lden
BP_75_D	ENKA overig	10.5	43.59	41.62	35.95	45.08
BP_7_A	ENKA	1.5	35.46	32.51	26.94	36.38
BP_7_B	ENKA	5.0	37.38	34.52	28.97	38.36
BP_7_C	ENKA	7.5	38.36	35.52	29.97	39.35
BP_7_D	ENKA	10.5	40.80	37.93	32.39	41.78
BP_8_A	ENKA	1.5	39.07	36.13	30.51	39.98
BP_8_B	ENKA	5.0	40.69	37.83	32.22	41.65
BP_8_C	ENKA	7.5	41.03	38.16	32.56	41.99
BP_8_D	ENKA	10.5	41.10	38.22	32.62	42.05
BP_9_A	ENKA	1.5	34.62	31.85	26.25	35.64
BP_9_B	ENKA	5.0	36.57	33.84	28.26	37.62
BP_9_C	ENKA	7.5	37.76	35.02	29.46	38.81
BP_9_D	ENKA	10.5	40.22	37.43	31.89	41.25

Alle getoonde dB-waarden zijn A-gewogen

Resultaten Spoorlijn Utrecht – Duitse grens, situatie 200 km/uur

Model: Situatie 2010-2015 200 km/u zonder maatregelen - Op basis toekomstprognose 2010/15 - Railverkeerslawaaï - Besluit MER Ede-Oost
 Bijdrage van hoofdgroep op alle ontvangerpunten
 Rekenmethode Railverkeerslawaaï - RMR-2006; Periode: Alle perioden

Id	Omschrijving	Hoogte	Dag	Avond	Nacht	Lden
BP_10_A	ENKA	1.5	35.55	32.90	27.27	36.63
BP_10_B	ENKA	5.0	37.49	34.88	29.27	38.60
BP_10_C	ENKA	7.5	38.69	36.08	30.49	39.81
BP_10_D	ENKA	10.5	41.60	38.95	33.37	42.70
BP_11_A	ENKA	1.5	38.93	36.31	30.63	40.01
BP_11_B	ENKA	5.0	40.63	38.06	32.40	41.74
BP_11_C	ENKA	7.5	40.91	38.32	32.67	42.02
BP_11_D	ENKA	10.5	41.06	38.44	32.80	42.15
BP_12_A	ENKA	1.5	30.82	28.24	22.62	31.94
BP_12_B	ENKA	5.0	33.58	31.01	25.44	34.73
BP_12_C	ENKA	7.5	35.15	32.59	27.03	36.31
BP_12_D	ENKA	10.5	38.93	36.33	30.75	40.06
BP_13_A	ENKA	1.5	33.20	30.62	25.01	34.33
BP_13_B	ENKA	5.0	35.76	33.20	27.62	36.91
BP_13_C	ENKA	7.5	37.03	34.47	28.89	38.18
BP_13_D	ENKA	10.5	41.09	38.45	32.87	42.19
BP_14_A	ENKA	1.5	39.03	36.39	30.72	40.10
BP_14_B	ENKA	5.0	40.88	38.30	32.65	41.99
BP_14_C	ENKA	7.5	41.34	38.74	33.09	42.44
BP_14_D	ENKA	10.5	41.50	38.89	33.24	42.59
BP_15_A	ENKA	1.5	38.86	36.22	30.55	39.93
BP_15_B	ENKA	5.0	40.77	38.20	32.55	41.89
BP_15_C	ENKA	7.5	41.17	38.58	32.93	42.28
BP_15_D	ENKA	10.5	41.44	38.81	33.17	42.53
BP_16_A	ENKA	1.5	37.28	34.69	29.05	38.39
BP_16_B	ENKA	5.0	39.49	36.94	31.31	40.63
BP_16_C	ENKA	7.5	40.33	37.74	32.12	41.45
BP_16_D	ENKA	10.5	42.09	39.45	33.83	43.18
BP_17_A	ENKA	1.5	34.37	31.88	26.23	35.54
BP_17_B	ENKA	5.0	37.26	34.77	29.14	38.44
BP_17_C	ENKA	7.5	38.95	36.39	30.79	40.09
BP_17_D	ENKA	10.5	41.78	39.15	33.54	42.88
BP_18_A	ENKA	1.5	33.53	30.98	25.35	34.67
BP_18_B	ENKA	5.0	36.59	34.04	28.43	37.74
BP_18_C	ENKA	7.5	38.49	35.91	30.31	39.62
BP_18_D	ENKA	10.5	41.47	38.83	33.23	42.57
BP_19_A	ENKA	1.5	33.30	30.72	25.12	34.43
BP_19_B	ENKA	5.0	36.77	34.19	28.62	37.91
BP_19_C	ENKA	7.5	38.72	36.13	30.55	39.85
BP_19_D	ENKA	10.5	41.69	39.08	33.47	42.80
BP_20_A	ENKA	1.5	32.33	29.66	24.00	33.38
BP_20_B	ENKA	5.0	34.85	32.21	26.61	35.95
BP_20_C	ENKA	7.5	36.14	33.49	27.90	37.23
BP_20_D	ENKA	10.5	35.90	33.28	27.70	37.02
BP_21_A	ENKA	1.5	34.76	32.20	26.62	35.91
BP_21_B	ENKA	5.0	37.97	35.45	29.88	39.15
BP_21_C	ENKA	7.5	39.34	36.80	31.22	40.50
BP_21_D	ENKA	10.5	42.20	39.61	34.00	43.32
BP_22_A	ENKA	1.5	36.16	33.60	28.03	37.32
BP_22_B	ENKA	5.0	40.04	37.49	31.93	41.21
BP_22_C	ENKA	7.5	41.51	39.01	33.43	42.70
BP_22_D	ENKA	10.5	43.41	40.94	35.32	44.60
BP_23_A	ENKA	1.5	36.68	34.13	28.55	37.84
BP_23_B	ENKA	5.0	40.75	38.20	32.64	41.92
BP_23_C	ENKA	7.5	42.12	39.65	34.06	43.32
BP_23_D	ENKA	10.5	43.64	41.21	35.59	44.86
BP_24_A	ENKA	1.5	35.36	32.97	27.35	36.60
BP_24_B	ENKA	5.0	38.92	36.46	30.88	40.13
BP_24_C	ENKA	7.5	40.32	37.85	32.27	41.53
BP_24_D	ENKA	10.5	43.08	40.57	34.98	44.26
BP_25_A	ENKA	1.5	32.64	30.18	24.58	33.85
BP_25_B	ENKA	5.0	35.75	33.29	27.72	36.97
BP_25_C	ENKA	7.5	37.39	34.91	29.35	38.60
BP_25_D	ENKA	10.5	39.88	37.38	31.83	41.08
BP_26_A	ENKA	1.5	31.67	29.14	23.55	32.84
BP_26_B	ENKA	5.0	35.70	33.16	27.59	36.87
BP_26_C	ENKA	7.5	39.14	36.56	31.01	40.29
BP_26_D	ENKA	10.5	41.78	39.19	33.62	42.92
BP_27_A	ENKA	1.5	31.08	28.53	22.93	32.23
BP_27_B	ENKA	5.0	35.06	32.51	26.93	36.22
BP_27_C	ENKA	7.5	37.99	35.42	29.85	39.14
BP_27_D	ENKA	10.5	41.25	38.65	33.06	42.37
BP_28_A	ENKA	1.5	29.98	27.40	21.78	31.10
BP_28_B	ENKA	5.0	33.66	31.06	25.45	34.78
BP_28_C	ENKA	7.5	37.06	34.42	28.83	38.16
BP_28_D	ENKA	10.5	41.33	38.73	33.09	42.43
BP_29_A	ENKA	1.5	31.52	28.94	23.33	32.65
BP_29_B	ENKA	5.0	35.71	33.11	27.54	36.84
BP_29_C	ENKA	7.5	38.36	35.74	30.17	39.48
BP_29_D	ENKA	10.5	42.43	39.83	34.23	43.55
BP_30_A	ENKA	1.5	32.20	29.65	24.04	33.35
BP_30_B	ENKA	5.0	35.57	32.99	27.40	36.71
BP_30_C	ENKA	7.5	37.89	35.29	29.69	39.01
BP_30_D	ENKA	10.5	41.89	39.30	33.65	43.00
BP_31_A	ENKA	1.5	39.25	36.61	30.94	40.32
BP_31_B	ENKA	5.0	41.02	38.43	32.78	42.13
BP_31_C	ENKA	7.5	41.33	38.73	33.08	42.43
BP_31_D	ENKA	10.5	41.16	38.56	32.91	42.26
BP_32_A	ENKA	1.5	29.65	27.12	21.50	30.81

Alle getoonde dB-waarden zijn A-gewogen

Model: Situatie 2010-2015 200_km/u zonder maatregelen - Op basis toekomstprognose 2010/15 - Railverkeerslawaaï - Besluit MER Ede-Oost
 Bijdrage van hoofdgroep op alle ontvangerpunten
 Rekenmethode Railverkeerslawaaï - RMR-2006; Periode: Alle perioden

Id	Omschrijving	Hoogte	Dag	Avond	Nacht	Lden
BP_30_B	ENKA	5.0	32.62	30.10	24.51	33.79
BP_30_C	ENKA	7.5	35.34	32.79	27.22	36.50
BP_30_D	ENKA	10.5	38.95	36.37	30.79	40.09
BP_31_A	ENKA	1.5	32.93	30.25	24.59	33.98
BP_31_B	ENKA	5.0	35.26	32.66	27.03	36.37
BP_31_C	ENKA	7.5	35.45	32.76	27.14	36.51
BP_31_D	ENKA	10.5	21.26	18.93	13.35	22.56
BP_32_A	ENKA	1.5	36.03	33.49	27.86	37.18
BP_32_B	ENKA	5.0	38.66	36.13	30.53	39.82
BP_32_C	ENKA	7.5	40.05	37.50	31.91	41.20
BP_32_D	ENKA	10.5	42.51	39.92	34.32	43.64
BP_33_A	ENKA	1.5	29.44	26.88	21.29	30.59
BP_33_B	ENKA	5.0	33.42	30.83	25.26	34.56
BP_33_C	ENKA	7.5	35.85	33.26	27.69	36.99
BP_33_D	ENKA	10.5	39.74	37.18	31.60	40.89
BP_34_A	ENKA	1.5	32.56	29.92	24.31	33.65
BP_34_B	ENKA	5.0	35.11	32.49	26.90	36.22
BP_34_C	ENKA	7.5	36.51	33.86	28.26	37.60
BP_34_D	ENKA	10.5	39.62	37.00	31.36	40.71
BP_35_A	ENKA	1.5	32.59	29.94	24.33	33.68
BP_35_B	ENKA	5.0	35.04	32.42	26.84	36.16
BP_35_C	ENKA	7.5	36.43	33.80	28.21	37.54
BP_35_D	ENKA	10.5	39.26	36.62	31.01	40.35
BP_36_A	ENKA	1.5	30.35	27.71	22.08	31.43
BP_36_B	ENKA	5.0	33.05	30.46	24.86	34.18
BP_36_C	ENKA	7.5	34.57	31.98	26.39	35.70
BP_36_D	ENKA	10.5	37.72	35.13	29.53	38.85
BP_37_A	ENKA	1.5	32.15	29.55	23.96	33.27
BP_37_B	ENKA	5.0	36.30	33.67	28.11	37.42
BP_37_C	ENKA	7.5	38.86	36.23	30.67	39.98
BP_37_D	ENKA	10.5	41.38	38.85	33.24	42.54
BP_38_A	ENKA	1.5	31.89	29.29	23.70	33.01
BP_38_B	ENKA	5.0	35.87	33.25	27.68	36.99
BP_38_C	ENKA	7.5	38.62	36.00	30.44	39.74
BP_38_D	ENKA	10.5	40.99	38.46	32.86	42.15
BP_39_A	ENKA	1.5	31.76	29.16	23.57	32.88
BP_39_B	ENKA	5.0	35.69	33.07	27.51	36.81
BP_39_C	ENKA	7.5	38.29	35.66	30.11	39.41
BP_39_D	ENKA	10.5	40.98	38.42	32.84	42.13
BP_3_A	ENKA	1.5	34.46	31.96	26.32	35.63
BP_3_B	ENKA	5.0	36.48	34.01	28.39	37.67
BP_3_C	ENKA	7.5	37.77	35.25	29.66	38.94
BP_3_D	ENKA	10.5	40.48	37.90	32.31	41.62
BP_40_A	ENKA	1.5	31.90	29.30	23.72	33.03
BP_40_B	ENKA	5.0	35.84	33.23	27.66	36.97
BP_40_C	ENKA	7.5	38.34	35.73	30.18	39.47
BP_40_D	ENKA	10.5	40.88	38.31	32.73	42.03
BP_41_A	ENKA	1.5	31.95	29.36	23.77	33.08
BP_41_B	ENKA	5.0	35.52	32.93	27.37	36.66
BP_41_C	ENKA	7.5	38.49	35.91	30.35	39.64
BP_41_D	ENKA	10.5	41.14	38.53	32.95	42.26
BP_42_A	ENKA	1.5	31.33	28.74	23.13	32.45
BP_42_B	ENKA	5.0	35.38	32.79	27.22	36.52
BP_42_C	ENKA	7.5	37.51	34.95	29.37	38.66
BP_42_D	ENKA	10.5	40.67	38.10	32.50	41.81
BP_43_A	ENKA	1.5	31.57	28.99	23.38	32.70
BP_43_B	ENKA	5.0	35.75	33.15	27.58	36.88
BP_43_C	ENKA	7.5	38.14	35.57	29.99	39.29
BP_43_D	ENKA	10.5	40.79	38.21	32.60	41.92
BP_4_A	ENKA	1.5	35.31	32.66	27.03	36.39
BP_4_B	ENKA	5.0	37.28	34.66	29.06	38.39
BP_4_C	ENKA	7.5	38.19	35.58	29.98	39.30
BP_4_D	ENKA	10.5	40.20	37.55	31.96	41.29
BP_51_A	ENKA overig	1.5	42.01	39.52	33.79	43.15
BP_51_B	ENKA overig	5.0	44.47	42.00	36.31	45.63
BP_51_C	ENKA overig	7.5	44.84	42.37	36.67	46.00
BP_51_D	ENKA overig	10.5	44.90	42.41	36.72	46.05
BP_52_A	ENKA overig	1.5	42.58	40.18	34.42	43.76
BP_52_B	ENKA overig	5.0	45.00	42.60	36.89	46.20
BP_52_C	ENKA overig	7.5	45.37	42.96	37.24	46.56
BP_52_D	ENKA overig	10.5	45.44	43.00	37.29	46.62
BP_53_A	ENKA overig	1.5	43.65	41.29	35.53	44.86
BP_53_B	ENKA overig	5.0	46.13	43.76	38.03	47.34
BP_53_C	ENKA overig	7.5	46.56	44.18	38.45	47.76
BP_53_D	ENKA overig	10.5	46.95	44.54	38.82	48.14
BP_54_A	ENKA overig	1.5	45.11	42.89	37.10	46.39
BP_54_B	ENKA overig	5.0	47.60	45.34	39.59	48.87
BP_54_C	ENKA overig	7.5	48.28	46.00	40.24	49.54
BP_54_D	ENKA overig	10.5	48.96	46.65	40.91	50.20
BP_55_A	ENKA overig	1.5	45.35	43.28	37.47	46.72
BP_55_B	ENKA overig	5.0	48.02	45.86	40.09	49.35
BP_55_C	ENKA overig	7.5	48.88	46.70	40.93	50.19
BP_55_D	ENKA overig	10.5	49.70	47.50	41.73	51.00
BP_56_A	ENKA overig	1.5	44.45	42.36	36.54	45.80
BP_56_B	ENKA overig	5.0	47.26	45.07	39.31	48.57
BP_56_C	ENKA overig	7.5	48.19	45.99	40.22	49.49
BP_56_D	ENKA overig	10.5	48.99	46.78	41.01	50.29
BP_57_A	ENKA overig	1.5	42.59	40.40	34.58	43.88
BP_57_B	ENKA overig	5.0	46.02	43.72	37.96	47.26

Alle getoonde dB-waarden zijn A-gewogen

Model: Situatie 2010-2015 200_km/u zonder maatregelen - Op basis toekomstprognose 2010/15 - Railverkeerslawaaï - Besluit MER Ede-Oost
 Bijdrage van hoofdgroep op alle ontvangerpunten
 Rekenmethode Railverkeerslawaaï - RMR-2006; Periode: Alle perioden

Id	Omschrijving	Hoogte	Dag	Avond	Nacht	Lden
BP_57_C	ENKA overig	10.0	47.67	45.34	39.59	48.90
BP_57_D	ENKA overig	15.0	48.66	46.29	40.53	49.86
BP_57_E	ENKA overig	20.0	49.29	46.86	41.10	50.45
BP_58_A	ENKA overig	1.5	49.91	48.30	42.44	51.56
BP_58_B	ENKA overig	5.0	54.58	52.62	46.81	56.02
BP_58_C	ENKA overig	10.0	56.78	54.63	48.84	58.11
BP_58_D	ENKA overig	15.0	58.00	55.72	49.93	59.24
BP_58_E	ENKA overig	20.0	58.87	56.42	50.63	60.01
BP_59_A	ENKA overig	1.5	55.27	53.72	47.88	56.96
BP_59_B	ENKA overig	5.0	60.98	58.89	53.12	62.35
BP_59_C	ENKA overig	10.0	63.57	61.26	55.49	64.80
BP_59_D	ENKA overig	15.0	65.09	62.55	56.78	66.18
BP_59_E	ENKA overig	20.0	65.92	63.15	57.44	66.89
BP_5_A	ENKA	1.5	39.35	36.73	31.06	40.43
BP_5_B	ENKA	5.0	40.89	38.31	32.66	42.00
BP_5_C	ENKA	7.5	41.23	38.64	32.99	42.34
BP_5_D	ENKA	10.0	41.23	38.64	32.99	42.34
BP_60_A	ENKA overig	1.5	55.00	53.46	47.62	56.70
BP_60_B	ENKA overig	5.0	60.43	58.38	52.60	61.82
BP_60_C	ENKA overig	10.0	63.49	61.11	55.36	64.69
BP_60_D	ENKA overig	15.0	64.82	62.29	56.55	65.93
BP_60_E	ENKA overig	20.0	65.65	62.93	57.22	66.65
BP_61_A	ENKA overig	1.5	54.71	53.17	47.34	56.41
BP_61_B	ENKA overig	5.0	59.94	57.93	52.17	61.37
BP_61_C	ENKA overig	10.0	63.06	60.71	54.98	64.28
BP_61_D	ENKA overig	15.0	64.61	62.08	56.37	65.73
BP_61_E	ENKA overig	20.0	65.35	62.72	57.02	66.41
BP_62_A	ENKA overig	1.5	54.47	52.94	47.11	56.18
BP_62_B	ENKA overig	5.0	59.37	57.39	51.64	60.82
BP_62_C	ENKA overig	7.5	61.20	58.99	53.27	62.52
BP_62_D	ENKA overig	10.5	62.82	60.49	54.77	64.06
BP_62_E	ENKA overig	13.5	63.82	61.38	55.67	65.00
BP_63_A	ENKA overig	1.5	54.27	52.73	46.91	55.98
BP_63_B	ENKA overig	5.0	58.91	56.96	51.23	60.39
BP_63_C	ENKA overig	7.5	60.64	58.53	52.80	62.01
BP_63_D	ENKA overig	10.5	62.29	60.01	54.30	63.57
BP_63_E	ENKA overig	13.5	63.54	61.13	55.44	64.74
BP_64_A	ENKA overig	1.5	54.11	52.57	46.76	55.82
BP_64_B	ENKA overig	5.0	58.63	56.70	50.97	60.12
BP_64_C	ENKA overig	7.5	60.35	58.27	52.55	61.75
BP_64_D	ENKA overig	10.5	61.93	59.66	53.97	63.22
BP_64_E	ENKA overig	13.5	63.20	60.84	55.15	64.43
BP_65_A	ENKA overig	1.5	48.00	46.35	40.57	49.65
BP_65_B	ENKA overig	5.0	51.31	49.48	43.75	52.86
BP_65_C	ENKA overig	7.5	52.39	50.53	44.80	53.93
BP_65_D	ENKA overig	10.5	53.67	51.73	46.00	55.15
BP_66_A	ENKA overig	1.5	50.40	48.73	42.95	52.04
BP_66_B	ENKA overig	5.0	53.89	52.05	46.32	55.44
BP_66_C	ENKA overig	7.5	55.14	53.23	47.51	56.65
BP_66_D	ENKA overig	10.5	56.68	54.65	48.93	58.11
BP_67_A	ENKA overig	1.5	51.05	49.27	43.52	52.63
BP_67_B	ENKA overig	5.0	54.42	52.48	46.78	55.92
BP_67_C	ENKA overig	7.5	55.67	53.68	47.98	57.13
BP_67_D	ENKA overig	10.5	57.23	55.13	49.44	58.63
BP_68_A	ENKA overig	1.5	51.67	49.81	44.09	53.21
BP_68_B	ENKA overig	5.0	54.58	52.60	46.92	56.06
BP_68_C	ENKA overig	7.5	55.80	53.78	48.09	57.25
BP_68_D	ENKA overig	10.5	57.43	55.31	49.63	58.82
BP_69_A	ENKA overig	1.5	51.53	49.69	43.97	53.08
BP_69_B	ENKA overig	5.0	54.35	52.40	46.71	55.84
BP_69_C	ENKA overig	7.5	55.57	53.57	47.88	57.03
BP_69_D	ENKA overig	10.5	57.20	55.10	49.41	58.60
BP_6_A	ENKA	1.5	33.38	30.90	25.24	34.55
BP_6_B	ENKA	5.0	34.90	32.45	26.82	36.10
BP_6_C	ENKA	7.5	36.40	33.90	28.30	37.58
BP_6_D	ENKA	10.5	39.73	37.14	31.55	40.86
BP_70_A	ENKA overig	1.5	51.16	49.45	43.71	52.79
BP_70_B	ENKA overig	5.0	53.86	52.05	46.33	55.43
BP_70_C	ENKA overig	7.5	55.15	53.27	47.56	56.68
BP_70_D	ENKA overig	10.5	56.72	54.72	49.01	58.17
BP_71_A	ENKA overig	1.5	49.48	48.10	42.29	51.30
BP_71_B	ENKA overig	5.0	52.54	51.00	45.23	54.27
BP_71_C	ENKA overig	7.5	53.85	52.23	46.47	55.53
BP_71_D	ENKA overig	10.5	55.53	53.73	47.98	57.10
BP_72_A	ENKA overig	1.5	49.06	47.78	41.95	50.94
BP_72_B	ENKA overig	5.0	51.97	50.57	44.77	53.78
BP_72_C	ENKA overig	7.5	53.30	51.79	46.00	55.04
BP_72_D	ENKA overig	10.5	54.95	53.23	47.47	56.56
BP_73_A	ENKA overig	1.5	43.48	42.17	36.35	45.34
BP_73_B	ENKA overig	5.0	46.56	45.15	39.35	48.36
BP_73_C	ENKA overig	7.5	47.51	46.07	40.28	49.30
BP_73_D	ENKA overig	10.5	48.65	47.13	41.35	50.39
BP_74_A	ENKA overig	1.5	42.17	40.75	34.96	43.97
BP_74_B	ENKA overig	5.0	44.67	43.16	37.39	46.42
BP_74_C	ENKA overig	7.5	45.38	43.85	38.08	47.12
BP_74_D	ENKA overig	10.5	46.14	44.58	38.81	47.86
BP_75_A	ENKA overig	1.5	41.10	39.65	33.86	42.88
BP_75_B	ENKA overig	5.0	43.08	41.54	35.78	44.81
BP_75_C	ENKA overig	7.5	43.67	42.10	36.34	45.38

Alle getoonde dB-waarden zijn A-gewogen

Model: Situatie 2010-2015 200_km/u zonder maatregelen - Op basis toekomstprognose 2010/15 - Railverkeerslawaaï - Besluit MER Ede-Oost
Bijdrage van hoofdgroep op alle ontvangerpunten
Rekenmethode Railverkeerslawaaï - RMR-2006; Periode: Alle perioden

Id	Omschrijving	Hoogte	Dag	Avond	Nacht	Lden
BP_75_D	ENKA overig	10.5	44.33	42.73	36.98	46.03
BP_7_A	ENKA	1.5	35.76	33.10	27.47	36.83
BP_7_B	ENKA	5.0	37.65	35.03	29.43	38.76
BP_7_C	ENKA	7.5	38.62	36.00	30.40	39.73
BP_7_D	ENKA	10.5	41.04	38.39	32.80	42.13
BP_8_A	ENKA	1.5	39.42	36.81	31.13	40.50
BP_8_B	ENKA	5.0	41.01	38.44	32.78	42.12
BP_8_C	ENKA	7.5	41.35	38.75	33.10	42.45
BP_8_D	ENKA	10.5	41.42	38.82	33.17	42.52
BP_9_A	ENKA	1.5	34.97	32.49	26.84	36.14
BP_9_B	ENKA	5.0	36.88	34.40	28.77	38.06
BP_9_C	ENKA	7.5	38.02	35.50	29.90	39.19
BP_9_D	ENKA	10.5	40.46	37.87	32.29	41.59

Alle getoonde dB-waarden zijn A-gewogen

Ligging geluidsscherms langs baan ter hoogte van Enka terrein, scherm 2 m+ BS langs baan

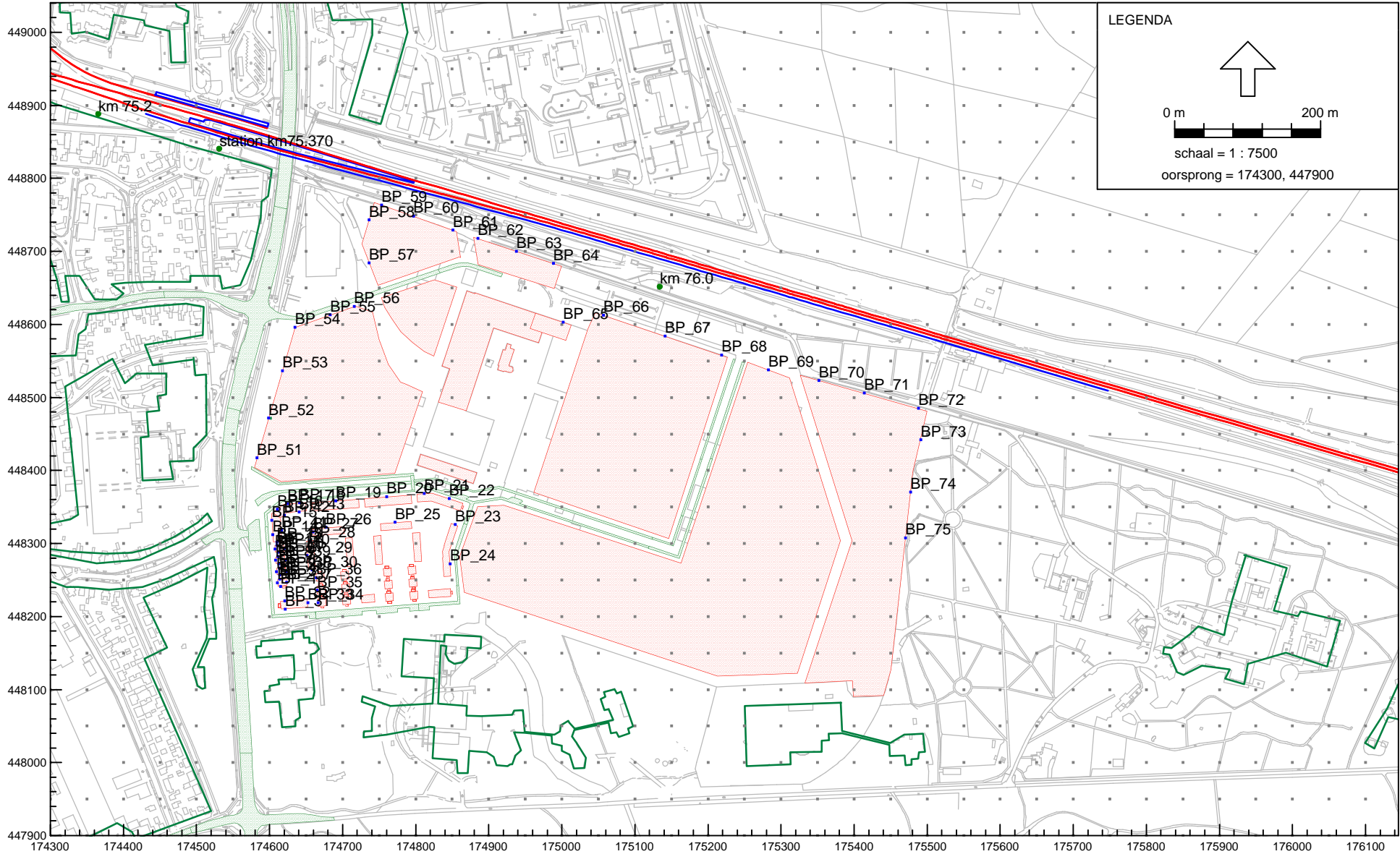

Railverkeerslawaaï - RMR-2006, Railverkeerslawaaï - Op basis toekomstprognose 2010/15 - Situatie 2010-2015 140_km/u Scherm 2m Baan [C:\PROJECTDATA\Ede Oost\Ede_spoor\Geonoise_Ede-oost], Geonoise V5.43

Overzicht ligging geluidsscherm (2m+ langs baan)

Resultaten Spoorlijn Utrecht – Duitse grens, oorspronkelijke situatie (140 km/uur) inclusief
2 m+ scherm langs baan

Model: Situatie 2010-2015 140_km/u Scherm 2m Baan - Op basis toekomstprognose 2010/15 - Railverkeerslawaaï - Besluit MER Ede-Oost
 Bijdrage van hoofdgroep op alle ontvangerpunten
 Rekenmethode Railverkeerslawaaï - RMR-2006; Periode: Alle perioden

Id	Omschrijving	Hoogte	Dag	Avond	Nacht	Lden
BP_10_A	ENKA	1.5	35.14	32.12	26.56	36.02
BP_10_B	ENKA	5.0	37.14	34.21	28.67	38.08
BP_10_C	ENKA	7.5	38.38	35.51	29.97	39.36
BP_10_D	ENKA	10.5	41.27	38.40	32.87	42.25
BP_11_A	ENKA	1.5	38.31	35.21	29.62	39.13
BP_11_B	ENKA	5.0	40.07	37.06	31.49	40.95
BP_11_C	ENKA	7.5	40.35	37.35	31.78	41.24
BP_11_D	ENKA	10.5	40.54	37.54	31.97	41.43
BP_12_A	ENKA	1.5	30.40	27.50	21.95	31.36
BP_12_B	ENKA	5.0	33.41	30.65	25.13	34.46
BP_12_C	ENKA	7.5	34.99	32.27	26.75	36.07
BP_12_D	ENKA	10.5	38.93	36.15	30.61	39.96
BP_13_A	ENKA	1.5	32.79	29.84	24.30	33.72
BP_13_B	ENKA	5.0	35.44	32.60	27.08	36.44
BP_13_C	ENKA	7.5	36.73	33.91	28.38	37.74
BP_13_D	ENKA	10.5	41.03	38.22	32.69	42.05
BP_14_A	ENKA	1.5	38.45	35.34	29.75	39.31
BP_14_B	ENKA	5.0	40.38	37.38	31.80	41.27
BP_14_C	ENKA	7.5	40.79	37.79	32.22	41.68
BP_14_D	ENKA	10.5	41.05	38.06	32.48	41.94
BP_15_A	ENKA	1.5	38.30	35.20	29.61	39.12
BP_15_B	ENKA	5.0	40.22	37.21	31.65	41.11
BP_15_C	ENKA	7.5	40.72	37.74	32.17	41.62
BP_15_D	ENKA	10.5	41.05	38.08	32.51	41.96
BP_16_A	ENKA	1.5	36.74	33.73	28.17	37.63
BP_16_B	ENKA	5.0	38.98	36.05	30.50	39.92
BP_16_C	ENKA	7.5	40.23	37.34	31.79	41.19
BP_16_D	ENKA	10.5	41.48	38.55	33.00	42.42
BP_17_A	ENKA	1.5	33.75	30.83	25.27	34.69
BP_17_B	ENKA	5.0	36.84	34.01	28.46	37.84
BP_17_C	ENKA	7.5	38.56	35.73	30.19	39.56
BP_17_D	ENKA	10.5	41.09	38.23	32.68	42.07
BP_18_A	ENKA	1.5	32.99	30.09	24.53	33.94
BP_18_B	ENKA	5.0	36.26	33.44	27.90	37.27
BP_18_C	ENKA	7.5	38.25	35.44	29.90	39.27
BP_18_D	ENKA	10.5	40.79	37.92	32.38	41.77
BP_19_A	ENKA	1.5	32.99	30.15	24.61	33.99
BP_19_B	ENKA	5.0	36.55	33.78	28.25	37.59
BP_19_C	ENKA	7.5	38.77	36.01	30.47	39.82
BP_19_D	ENKA	10.5	41.12	38.26	32.72	42.11
BP_1_A	ENKA	1.5	31.83	28.79	23.20	32.69
BP_1_B	ENKA	5.0	34.51	31.62	26.07	35.47
BP_1_C	ENKA	7.5	36.05	33.21	27.67	37.05
BP_1_D	ENKA	10.5	35.49	32.70	27.15	36.51
BP_20_A	ENKA	1.5	34.42	31.65	26.12	35.46
BP_20_B	ENKA	5.0	37.65	34.92	29.40	38.72
BP_20_C	ENKA	7.5	39.31	36.57	31.04	40.37
BP_20_D	ENKA	10.5	41.63	38.76	33.21	42.61
BP_21_A	ENKA	1.5	35.90	33.13	27.60	36.94
BP_21_B	ENKA	5.0	39.80	37.08	31.56	40.88
BP_21_C	ENKA	7.5	41.01	38.26	32.74	42.07
BP_21_D	ENKA	10.5	42.70	39.87	34.34	43.71
BP_22_A	ENKA	1.5	36.39	33.60	28.08	37.43
BP_22_B	ENKA	5.0	40.45	37.72	32.21	41.53
BP_22_C	ENKA	7.5	41.51	38.76	33.24	42.57
BP_22_D	ENKA	10.5	42.83	40.03	34.49	43.85
BP_23_A	ENKA	1.5	34.64	31.84	26.32	35.67
BP_23_B	ENKA	5.0	38.41	35.68	30.16	39.48
BP_23_C	ENKA	7.5	39.85	37.11	31.60	40.92
BP_23_D	ENKA	10.5	42.53	39.76	34.24	43.58
BP_24_A	ENKA	1.5	32.08	29.31	23.79	33.13
BP_24_B	ENKA	5.0	35.29	32.57	27.06	36.37
BP_24_C	ENKA	7.5	36.97	34.26	28.76	38.06
BP_24_D	ENKA	10.5	39.65	36.98	31.48	40.77
BP_25_A	ENKA	1.5	31.31	28.47	22.94	32.31
BP_25_B	ENKA	5.0	35.48	32.71	27.19	36.53
BP_25_C	ENKA	7.5	39.02	36.30	30.79	40.10
BP_25_D	ENKA	10.5	41.28	38.48	32.95	42.31
BP_26_A	ENKA	1.5	30.74	27.90	22.36	31.74
BP_26_B	ENKA	5.0	34.82	32.03	26.51	35.86
BP_26_C	ENKA	7.5	37.86	35.12	29.60	38.93
BP_26_D	ENKA	10.5	40.66	37.83	32.29	41.66
BP_27_A	ENKA	1.5	29.63	26.75	21.19	30.60
BP_27_B	ENKA	5.0	33.52	30.67	25.12	34.51
BP_27_C	ENKA	7.5	36.89	34.05	28.51	37.89
BP_27_D	ENKA	10.5	40.96	38.04	32.47	41.90
BP_28_A	ENKA	1.5	31.18	28.32	22.77	32.16
BP_28_B	ENKA	5.0	35.59	32.81	27.28	36.63
BP_28_C	ENKA	7.5	38.36	35.57	30.04	39.39
BP_28_D	ENKA	10.5	42.04	39.20	33.65	43.03
BP_29_A	ENKA	1.5	31.82	28.93	23.39	32.79
BP_29_B	ENKA	5.0	35.19	32.35	26.81	36.19
BP_29_C	ENKA	7.5	37.80	34.97	29.42	38.80
BP_29_D	ENKA	10.5	41.42	38.46	32.89	42.33
BP_2_A	ENKA	1.5	38.67	35.57	29.99	39.50
BP_2_B	ENKA	5.0	40.46	37.46	31.89	41.35
BP_2_C	ENKA	7.5	40.76	37.77	32.19	41.65
BP_2_D	ENKA	10.5	40.55	37.56	31.99	41.45
BP_30_A	ENKA	1.5	29.21	26.32	20.78	30.18

Alle getoonde dB-waarden zijn A-gewogen

Model: Situatie 2010-2015 140_km/u Scherm 2m Baan - Op basis toekomstprognose 2010/15 - Railverkeerslawaaï - Besluit MER Ede-Oost
 Bijdrage van hoofdgroep op alle ontvangerpunten
 Rekenmethode Railverkeerslawaaï - RMR-2006; Periode: Alle perioden

Id	Omschrijving	Hoogte	Dag	Avond	Nacht	Lden
BP_30_B	ENKA	5.0	32.26	29.45	23.92	33.28
BP_30_C	ENKA	7.5	35.11	32.36	26.83	36.17
BP_30_D	ENKA	10.5	38.57	35.74	30.21	39.58
BP_31_A	ENKA	1.5	32.40	29.32	23.74	33.24
BP_31_B	ENKA	5.0	34.77	31.82	26.26	35.69
BP_31_C	ENKA	7.5	35.01	32.07	26.50	35.94
BP_31_D	ENKA	10.5	20.81	18.17	12.66	21.94
BP_32_A	ENKA	1.5	35.51	32.57	27.02	36.44
BP_32_B	ENKA	5.0	38.20	35.34	29.81	39.19
BP_32_C	ENKA	7.5	39.72	36.90	31.38	40.74
BP_32_D	ENKA	10.5	41.98	39.11	33.57	42.96
BP_33_A	ENKA	1.5	29.10	26.27	20.74	30.11
BP_33_B	ENKA	5.0	33.17	30.39	24.87	34.21
BP_33_C	ENKA	7.5	35.61	32.84	27.31	36.65
BP_33_D	ENKA	10.5	39.21	36.42	30.89	40.24
BP_34_A	ENKA	1.5	32.21	29.26	23.71	33.14
BP_34_B	ENKA	5.0	34.86	31.99	26.45	35.84
BP_34_C	ENKA	7.5	36.36	33.49	27.95	37.34
BP_34_D	ENKA	10.5	39.24	36.30	30.73	40.17
BP_35_A	ENKA	1.5	32.26	29.32	23.77	33.19
BP_35_B	ENKA	5.0	34.77	31.91	26.37	35.76
BP_35_C	ENKA	7.5	36.14	33.27	27.73	37.12
BP_35_D	ENKA	10.5	38.96	36.05	30.50	39.91
BP_36_A	ENKA	1.5	29.96	26.97	21.41	30.86
BP_36_B	ENKA	5.0	32.75	29.90	24.35	33.74
BP_36_C	ENKA	7.5	34.25	31.41	25.88	35.25
BP_36_D	ENKA	10.5	37.26	34.39	28.86	38.24
BP_37_A	ENKA	1.5	31.86	29.01	23.47	32.85
BP_37_B	ENKA	5.0	36.17	33.39	27.87	37.21
BP_37_C	ENKA	7.5	38.43	35.65	30.13	39.47
BP_37_D	ENKA	10.5	40.65	37.82	32.29	41.66
BP_38_A	ENKA	1.5	31.51	28.65	23.11	32.50
BP_38_B	ENKA	5.0	35.81	33.03	27.51	36.85
BP_38_C	ENKA	7.5	38.19	35.42	29.90	39.24
BP_38_D	ENKA	10.5	40.25	37.44	31.91	41.27
BP_39_A	ENKA	1.5	31.37	28.51	22.98	32.36
BP_39_B	ENKA	5.0	35.37	32.58	27.05	36.40
BP_39_C	ENKA	7.5	37.89	35.11	29.59	38.93
BP_39_D	ENKA	10.5	40.31	37.51	31.98	41.34
BP_3_A	ENKA	1.5	33.87	30.93	25.38	34.80
BP_3_B	ENKA	5.0	35.96	33.09	27.56	36.94
BP_3_C	ENKA	7.5	37.46	34.67	29.14	38.49
BP_3_D	ENKA	10.5	40.20	37.38	31.85	41.21
BP_40_A	ENKA	1.5	31.50	28.64	23.11	32.49
BP_40_B	ENKA	5.0	35.52	32.74	27.22	36.56
BP_40_C	ENKA	7.5	38.31	35.58	30.06	39.38
BP_40_D	ENKA	10.5	40.32	37.53	32.01	41.36
BP_41_A	ENKA	1.5	31.61	28.77	23.23	32.61
BP_41_B	ENKA	5.0	35.25	32.47	26.95	36.29
BP_41_C	ENKA	7.5	38.28	35.55	30.03	39.35
BP_41_D	ENKA	10.5	40.52	37.72	32.19	41.55
BP_42_A	ENKA	1.5	30.86	27.98	22.43	31.83
BP_42_B	ENKA	5.0	35.07	32.31	26.78	36.12
BP_42_C	ENKA	7.5	37.44	34.70	29.17	38.50
BP_42_D	ENKA	10.5	40.46	37.69	32.14	41.50
BP_43_A	ENKA	1.5	31.18	28.31	22.77	32.16
BP_43_B	ENKA	5.0	35.46	32.69	27.17	36.51
BP_43_C	ENKA	7.5	37.97	35.22	29.69	39.03
BP_43_D	ENKA	10.5	40.29	37.41	31.87	41.26
BP_4_A	ENKA	1.5	34.91	31.88	26.32	35.79
BP_4_B	ENKA	5.0	36.93	34.01	28.47	37.88
BP_4_C	ENKA	7.5	37.87	34.98	29.45	38.84
BP_4_D	ENKA	10.5	39.80	36.91	31.37	40.77
BP_51_A	ENKA overig	1.5	40.79	37.62	32.01	41.57
BP_51_B	ENKA overig	5.0	43.34	40.33	34.74	44.22
BP_51_C	ENKA overig	7.5	43.66	40.65	35.07	44.54
BP_51_D	ENKA overig	10.5	43.67	40.66	35.08	44.55
BP_52_A	ENKA overig	1.5	41.14	37.95	32.33	41.90
BP_52_B	ENKA overig	5.0	43.69	40.66	35.08	44.56
BP_52_C	ENKA overig	7.5	44.01	40.99	35.40	44.88
BP_52_D	ENKA overig	10.5	44.06	41.02	35.43	44.92
BP_53_A	ENKA overig	1.5	42.03	38.83	33.21	42.78
BP_53_B	ENKA overig	5.0	44.58	41.55	35.96	45.44
BP_53_C	ENKA overig	7.5	44.93	41.90	36.31	45.79
BP_53_D	ENKA overig	10.5	45.06	41.99	36.40	45.90
BP_54_A	ENKA overig	1.5	43.05	39.84	34.22	43.80
BP_54_B	ENKA overig	5.0	45.65	42.59	37.00	46.50
BP_54_C	ENKA overig	7.5	46.11	43.03	37.44	46.95
BP_54_D	ENKA overig	10.5	46.56	43.39	37.79	47.34
BP_55_A	ENKA overig	1.5	42.85	39.62	34.00	43.59
BP_55_B	ENKA overig	5.0	45.77	42.70	37.12	46.61
BP_55_C	ENKA overig	7.5	46.38	43.27	37.69	47.20
BP_55_D	ENKA overig	10.5	47.05	43.87	38.28	47.83
BP_56_A	ENKA overig	1.5	41.98	38.73	33.11	42.71
BP_56_B	ENKA overig	5.0	44.99	41.89	36.30	45.81
BP_56_C	ENKA overig	7.5	45.67	42.52	36.93	46.46
BP_56_D	ENKA overig	10.5	46.58	43.37	37.77	47.34
BP_57_A	ENKA overig	1.5	40.09	36.79	31.16	40.78
BP_57_B	ENKA overig	5.0	43.48	40.28	34.67	44.24

Alle getoonde dB-waarden zijn A-gewogen

Model: Situatie 2010-2015 140_km/u Scherm 2m Baan - Op basis toekomstprognose 2010/15 - Railverkeerslawaaï - Besluit MER Ede-Oost
 Bijdrage van hoofdgroep op alle ontvangerpunten
 Rekenmethode Railverkeerslawaaï - RMR-2006; Periode: Alle perioden

Id	Omschrijving	Hoogte	Dag	Avond	Nacht	Lden
BP_57_C	ENKA overig	10.0	46.05	42.79	37.19	46.78
BP_57_D	ENKA overig	15.0	47.08	43.83	38.23	47.81
BP_57_E	ENKA overig	20.0	47.66	44.32	38.71	48.34
BP_58_A	ENKA overig	1.5	45.94	42.66	37.06	46.66
BP_58_B	ENKA overig	5.0	50.99	47.81	42.24	51.77
BP_58_C	ENKA overig	10.0	54.28	50.96	45.38	54.98
BP_58_D	ENKA overig	15.0	55.53	52.05	46.46	56.13
BP_58_E	ENKA overig	20.0	56.48	52.90	47.29	57.02
BP_59_A	ENKA overig	1.5	51.04	47.88	42.31	51.84
BP_59_B	ENKA overig	5.0	57.15	53.99	48.43	57.95
BP_59_C	ENKA overig	10.0	61.06	57.68	52.11	61.73
BP_59_D	ENKA overig	15.0	62.68	59.21	53.61	63.29
BP_59_E	ENKA overig	20.0	64.36	60.86	55.23	64.94
BP_5_A	ENKA	1.5	38.77	35.69	30.11	39.61
BP_5_B	ENKA	5.0	40.37	37.38	31.81	41.27
BP_5_C	ENKA	7.5	40.68	37.69	32.12	41.58
BP_5_D	ENKA	10.5	40.65	37.67	32.09	41.55
BP_60_A	ENKA overig	1.5	50.77	47.65	42.09	51.59
BP_60_B	ENKA overig	5.0	56.69	53.61	48.06	57.54
BP_60_C	ENKA overig	10.0	60.75	57.44	51.86	61.46
BP_60_D	ENKA overig	15.0	62.72	59.36	53.77	63.39
BP_60_E	ENKA overig	20.0	63.87	60.44	54.83	64.50
BP_61_A	ENKA overig	1.5	50.58	47.53	41.98	51.45
BP_61_B	ENKA overig	5.0	56.32	53.35	47.81	57.24
BP_61_C	ENKA overig	10.0	60.34	57.19	51.63	61.15
BP_61_D	ENKA overig	15.0	62.70	59.48	53.92	63.46
BP_61_E	ENKA overig	20.0	63.70	60.46	54.87	64.44
BP_62_A	ENKA overig	1.5	50.38	47.36	41.82	51.27
BP_62_B	ENKA overig	5.0	56.00	53.06	47.53	56.94
BP_62_C	ENKA overig	7.5	57.75	54.67	49.13	58.60
BP_62_D	ENKA overig	10.5	60.08	56.98	51.42	60.91
BP_62_E	ENKA overig	13.5	61.50	58.33	52.77	62.29
BP_63_A	ENKA overig	1.5	50.20	47.24	41.70	51.13
BP_63_B	ENKA overig	5.0	55.71	52.83	47.30	56.69
BP_63_C	ENKA overig	7.5	57.18	54.22	48.69	58.11
BP_63_D	ENKA overig	10.5	59.16	56.06	50.53	60.01
BP_63_E	ENKA overig	13.5	60.88	57.78	52.24	61.72
BP_64_A	ENKA overig	1.5	50.07	47.13	41.60	51.01
BP_64_B	ENKA overig	5.0	55.48	52.62	47.10	56.47
BP_64_C	ENKA overig	7.5	56.83	53.93	48.41	57.80
BP_64_D	ENKA overig	10.5	58.70	55.62	50.09	59.56
BP_64_E	ENKA overig	13.5	60.50	57.47	51.94	61.39
BP_65_A	ENKA overig	1.5	44.38	41.48	35.95	45.34
BP_65_B	ENKA overig	5.0	48.41	45.61	40.10	49.44
BP_65_C	ENKA overig	7.5	49.54	46.72	41.22	50.56
BP_65_D	ENKA overig	10.5	50.86	48.03	42.52	51.87
BP_66_A	ENKA overig	1.5	46.82	43.94	38.42	47.80
BP_66_B	ENKA overig	5.0	50.98	48.18	42.67	52.01
BP_66_C	ENKA overig	7.5	52.26	49.44	43.93	53.28
BP_66_D	ENKA overig	10.5	53.49	50.65	45.14	54.50
BP_67_A	ENKA overig	1.5	47.79	44.96	39.44	48.80
BP_67_B	ENKA overig	5.0	51.77	49.00	43.50	52.82
BP_67_C	ENKA overig	7.5	53.04	50.26	44.76	54.09
BP_67_D	ENKA overig	10.5	54.28	51.49	45.98	55.32
BP_68_A	ENKA overig	1.5	48.67	45.88	40.37	49.71
BP_68_B	ENKA overig	5.0	52.02	49.27	43.77	53.09
BP_68_C	ENKA overig	7.5	53.25	50.49	44.99	54.31
BP_68_D	ENKA overig	10.5	54.49	51.71	46.21	55.54
BP_69_A	ENKA overig	1.5	48.51	45.73	40.22	49.56
BP_69_B	ENKA overig	5.0	51.73	48.99	43.49	52.80
BP_69_C	ENKA overig	7.5	52.95	50.20	44.70	54.02
BP_69_D	ENKA overig	10.5	54.19	51.43	45.93	55.25
BP_6_A	ENKA	1.5	32.73	29.78	24.22	33.65
BP_6_B	ENKA	5.0	34.32	31.44	25.90	35.29
BP_6_C	ENKA	7.5	36.09	33.30	27.77	37.12
BP_6_D	ENKA	10.5	39.45	36.63	31.10	40.46
BP_70_A	ENKA overig	1.5	47.85	45.08	39.57	48.90
BP_70_B	ENKA overig	5.0	50.89	48.14	42.64	51.96
BP_70_C	ENKA overig	7.5	52.15	49.39	43.89	53.21
BP_70_D	ENKA overig	10.5	53.37	50.59	45.08	54.42
BP_71_A	ENKA overig	1.5	45.20	42.38	36.86	46.22
BP_71_B	ENKA overig	5.0	48.91	46.14	40.64	49.96
BP_71_C	ENKA overig	7.5	50.17	47.39	41.89	51.22
BP_71_D	ENKA overig	10.5	51.55	48.75	43.24	52.58
BP_72_A	ENKA overig	1.5	44.42	41.60	36.09	45.44
BP_72_B	ENKA overig	5.0	47.87	45.09	39.59	48.92
BP_72_C	ENKA overig	7.5	49.19	46.40	40.90	50.23
BP_72_D	ENKA overig	10.5	50.54	47.73	42.23	51.57
BP_73_A	ENKA overig	1.5	39.32	36.50	30.99	40.34
BP_73_B	ENKA overig	5.0	42.86	40.10	34.60	43.92
BP_73_C	ENKA overig	7.5	43.80	41.04	35.54	44.86
BP_73_D	ENKA overig	10.5	44.86	42.08	36.58	45.91
BP_74_A	ENKA overig	1.5	38.52	35.71	30.20	39.55
BP_74_B	ENKA overig	5.0	41.52	38.77	33.27	42.59
BP_74_C	ENKA overig	7.5	42.30	39.53	34.04	43.36
BP_74_D	ENKA overig	10.5	43.07	40.30	34.80	44.12
BP_75_A	ENKA overig	1.5	37.64	34.88	29.38	38.70
BP_75_B	ENKA overig	5.0	40.17	37.45	31.96	41.26
BP_75_C	ENKA overig	7.5	40.80	38.08	32.58	41.89

Alle getoonde dB-waarden zijn A-gewogen

Model: Situatie 2010-2015 140_km/u Scherm 2m Baan - Op basis toekomstprognose 2010/15 - Railverkeerslawaaai - Besluit MER Ede-Oost
Bijdrage van hoofdgroep op alle ontvangerpunten
Rekenmethode Railverkeerslawaaai - RMR-2006; Periode: Alle perioden

Id	Omschrijving	Hoogte	Dag	Avond	Nacht	Lden
BP_75_D	ENKA overig	10.5	41.53	38.80	33.31	42.61
BP_7_A	ENKA	1.5	35.36	32.32	26.76	36.23
BP_7_B	ENKA	5.0	37.31	34.38	28.83	38.25
BP_7_C	ENKA	7.5	38.30	35.40	29.86	39.26
BP_7_D	ENKA	10.5	40.68	37.80	32.26	41.65
BP_8_A	ENKA	1.5	38.82	35.73	30.14	39.65
BP_8_B	ENKA	5.0	40.49	37.49	31.91	41.38
BP_8_C	ENKA	7.5	40.79	37.79	32.22	41.68
BP_8_D	ENKA	10.5	40.82	37.83	32.26	41.72
BP_9_A	ENKA	1.5	34.34	31.38	25.83	35.26
BP_9_B	ENKA	5.0	36.33	33.45	27.91	37.30
BP_9_C	ENKA	7.5	37.70	34.89	29.36	38.72
BP_9_D	ENKA	10.5	40.19	37.37	31.84	41.20

Alle getoonde dB-waarden zijn A-gewogen